



BID # CON 19-03

ADDENDUM NUMBER 04

REQUEST FOR BIDS FOR:

**NHTI Institute Drive Roadway Work & Campus Sidewalk Improvements
on the NHTI Concord's Community College campus, a Component
of the Community College System of New Hampshire
26 College Drive, Concord, NH
March 15, 2019**

TO: ALL CONTRACT BIDDERS OF RECORD

This Addendum forms a part of the Contract Documents and modifies the Request for Bids dated February 25, 2019 with amendments and additions noted below.

This Addendum consists of a total of Two (2) pages of clarifications and questions and One (1) drawing "C-2 Proposed Site Plan". Bids due date is: Tuesday, March 19th, 2019 at 3:00pm.

CLARIFICATIONS TO THE REQUEST FOR PROPOSAL:

- 1) Contractor is required to get a street excavation permit from the City of Concord. Per the City of Concord's review concerning permit fees: "Based on our review of the project we view it as a road improvement and, therefore, these fees do not apply. In addition, the City ROW is Delta Drive and the State owns the ROW for Institute Drive. As such, the majority of the project is located in the State's ROW. As part of the excavation permit we require inspection of the work in the City's ROW. For planning purposes, we estimate that the inspection effort will be around 36 hrs. (\$3,000)." Include \$3,000 allowance in the bid.
- 2) See attached drawing "C-2 Proposed Site Plan" that shows the extent of road work that is City of Concord Property that requires a street excavation permit from the city of Concord.
- 3) Contractor must submit a traffic control plan and is required to keep at least one lane of roadway open with flaggers or two lanes without flaggers to allow for traffic. Provide flaggers in traffic control within the bid.

**Acknowledge receipt of this Addendum with the Proposal Form.
Failure to do so may disqualify the Bidder.**

NOTE: IN THE EVENT THAT YOUR BID HAS BEEN SENT TO THIS OFFICE PRIOR TO RECEIVING THIS ADDENDUM, RETURN THE ADDENDUM WITHIN THE SPECIFIED TIME WITH ANY CHANGES YOU MAY WISH TO MAKE AND MARK ON THE REMITTANCE ENVELOPE BID INVITATION NUMBER AND OPENING DATE. RETURNED ADDENDA WILL SUPERSEDE PREVIOUSLY SUBMITTED BID.



Acknowledge receipt of this Addendum #4 with the Proposal Form.

Bidder _____

By _____ Date _____

(This Document Must Be Signed)

Name _____

(Please Print or Type Name)

A handwritten signature in black ink that reads "Matthew Moore". The signature is written over a horizontal line.

Matthew Moore, P.E.
Director of Capitol Planning & Development
Community College System of New Hampshire
26 College Drive, Concord, N.H. 0330

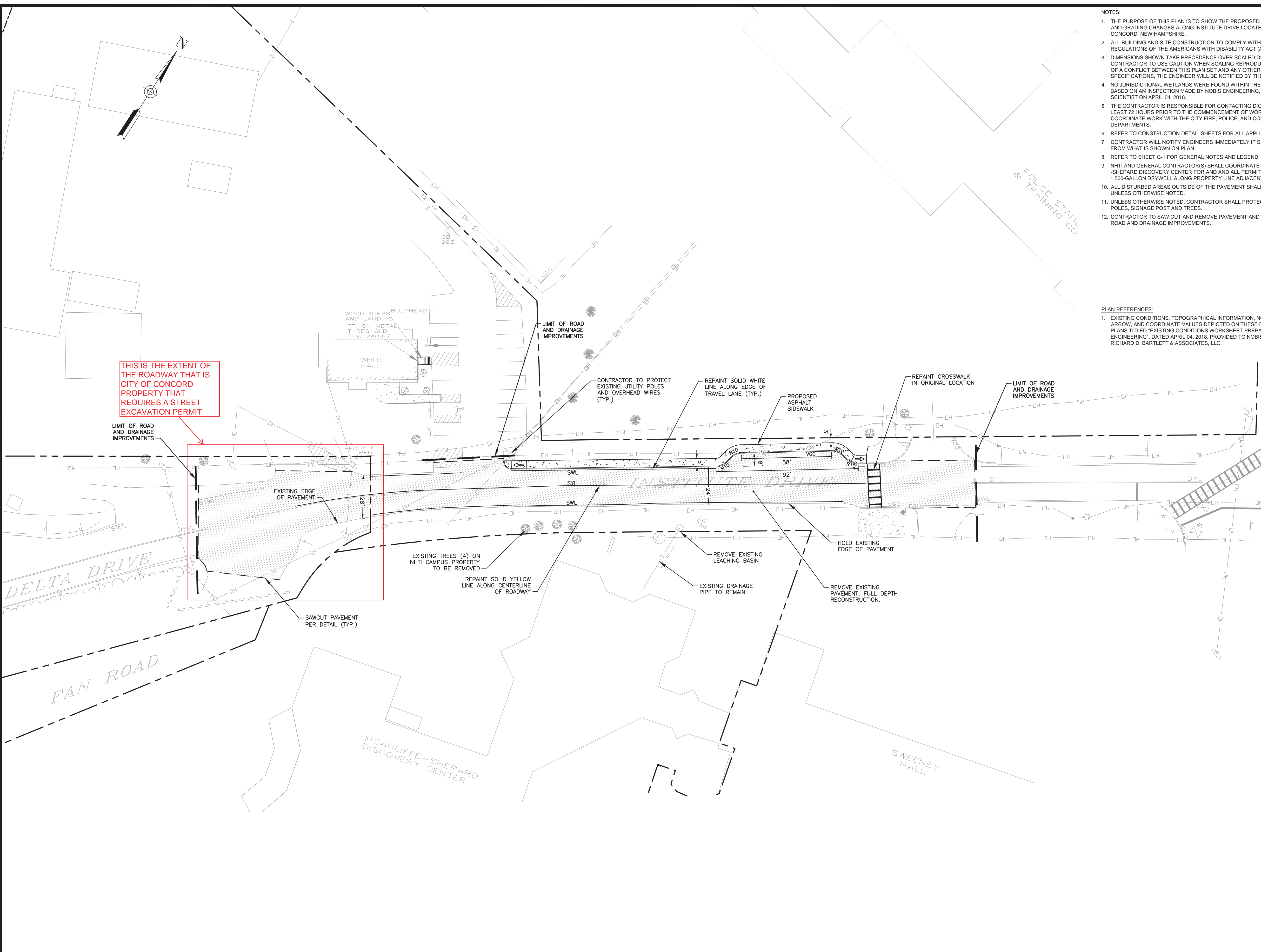

- NOTES:**
1. THE PURPOSE OF THIS PLAN IS TO SHOW THE PROPOSED DRAINAGE IMPROVEMENTS AND GRADING CHANGES ALONG INSTITUTE DRIVE LOCATED AT NHTI CAMPUS IN CONCORD, NEW HAMPSHIRE.
 2. ALL BUILDING AND SITE CONSTRUCTION TO COMPLY WITH THE RULES AND REGULATIONS OF THE AMERICANS WITH DISABILITY ACT (ADA) LATEST EDITION.
 3. DIMENSIONS SHOWN TAKE PRECEDENCE OVER SCALED DIMENSIONS. THE CONTRACTOR TO USE CAUTION WHEN SCALING REPRODUCED PLANS. IN THE EVENT OF A CONFLICT BETWEEN THIS PLAN SET AND ANY OTHER DRAWINGS AND / OR SPECIFICATIONS, THE ENGINEER WILL BE NOTIFIED BY THE CONTRACTOR.
 4. NO JURISDICTIONAL WETLANDS WERE FOUND WITHIN THE SPECIFIED PROJECT AREA BASED ON AN INSPECTION MADE BY NOBIS ENGINEERING, INC.'S CERTIFIED WETLAND SCIENTIST ON APRIL 04, 2018.
 5. THE CONTRACTOR IS RESPONSIBLE FOR CONTACTING DIG SAFE (1-888-DIG-SAFE) AT LEAST 72 HOURS PRIOR TO THE COMMENCEMENT OF WORK. THE CONTRACTOR WILL COORDINATE WORK WITH THE CITY FIRE, POLICE, AND COMMUNITY DEVELOPMENT DEPARTMENTS.
 6. REFER TO CONSTRUCTION DETAIL SHEETS FOR ALL APPLICABLE SITE DETAILS.
 7. CONTRACTOR WILL NOTIFY ENGINEERS IMMEDIATELY IF SITE CONDITIONS DIFFER FROM WHAT IS SHOWN ON PLAN.
 8. REFER TO SHEET G-1 FOR GENERAL NOTES AND LEGEND.
 9. NHTI AND GENERAL CONTRACTOR(S) SHALL COORDINATE WITH THE MCAULIFFE-SHEPARD DISCOVERY CENTER FOR AND ALL PERMITS TO INSTALL NEW 1,500-GALLON DRYWELL ALONG PROPERTY LINE ADJACENT TO INSTITUTE DRIVE.
 10. ALL DISTURBED AREAS OUTSIDE OF THE PAVEMENT SHALL BE LOAM AND SEEDED, UNLESS OTHERWISE NOTED.
 11. UNLESS OTHERWISE NOTED, CONTRACTOR SHALL PROTECT EXISTING UTILITIES, POLES, SIGNAGE POST AND TREES.
 12. CONTRACTOR TO SAW CUT AND REMOVE PAVEMENT AND SUB-BASE WITHIN LIMIT OF ROAD AND DRAINAGE IMPROVEMENTS.

- PLAN REFERENCES:**
1. EXISTING CONDITIONS, TOPOGRAPHICAL INFORMATION, NORTH ORIENTATION, NORTH ARROW, AND COORDINATE VALUES DEPICTED ON THESE DRAWINGS ARE BASED ON PLANS TITLED "EXISTING CONDITIONS WORKSHEET PREPARED FOR NOBIS ENGINEERING", DATED APRIL 04, 2018, PROVIDED TO NOBIS ENGINEERING, INC. BY RICHARD D. BARTLETT & ASSOCIATES, LLC.

Nobis
 Engineering a Sustainable Future
 Nobis Engineering, Inc.
 18 Chenell Drive
 Concord, NH 03301
 T(603) 224-4182
 www.nobiseng.com
 Client - Focused, Employee - Owned

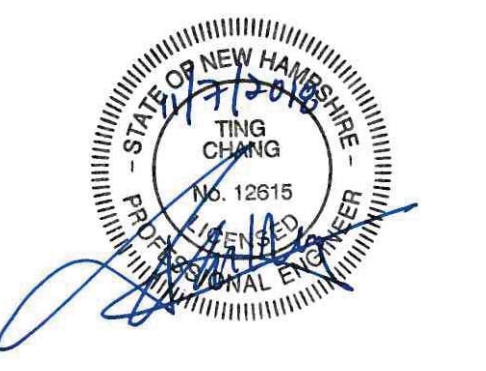

NOT ISSUED
 FOR
 CONSTRUCTION

NHTI - CONCORD'S
 COMMUNITY
 COLLEGE DRAINAGE
 IMPROVEMENTS
 INSTITUTE DRIVE
 CONCORD, NEW HAMPSHIRE

NO.	DATE	DESCRIPTION

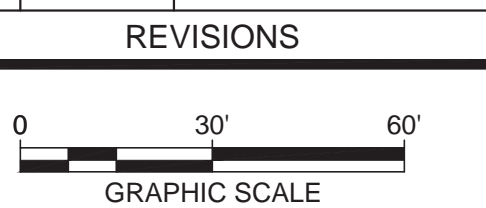

DATE:	NOVEMBER 2018
NOBIS PROJECT NO.	94300.00
DRAWN BY:	SMC
CHECKED BY:	TC
CAD DRAWING FILE:	94300.00-C-200-SITE.dwg
SHEET TITLE	

PROPOSED
 SITE PLAN

SHEET
C-2

J:\94300.00 - Drainage Improvements & Belg Code Improv\CAD\94300.00-C-200-SITE.dwg 11/19/2018 9:20 AM